

SKETCH OF LEVEL 5

at 22-26 York Street - Sydney
SHOWING NET LETTABLE AREA

NET LETTABLE AREA = 837 SQ. MT'S.

NOTES:

1. NET LETTABLE AREA DETERMINED USING THE PRINCIPLES CONTAINED IN THE "PROPERTY COUNCIL OF AUSTRALIA METHOD OF MEASUREMENT FOR LETTABLE AREA" (MARCH 1997 EDITION)
2. AREAS STATED TO THE NEAREST
3. COLUMNS INCLUDED

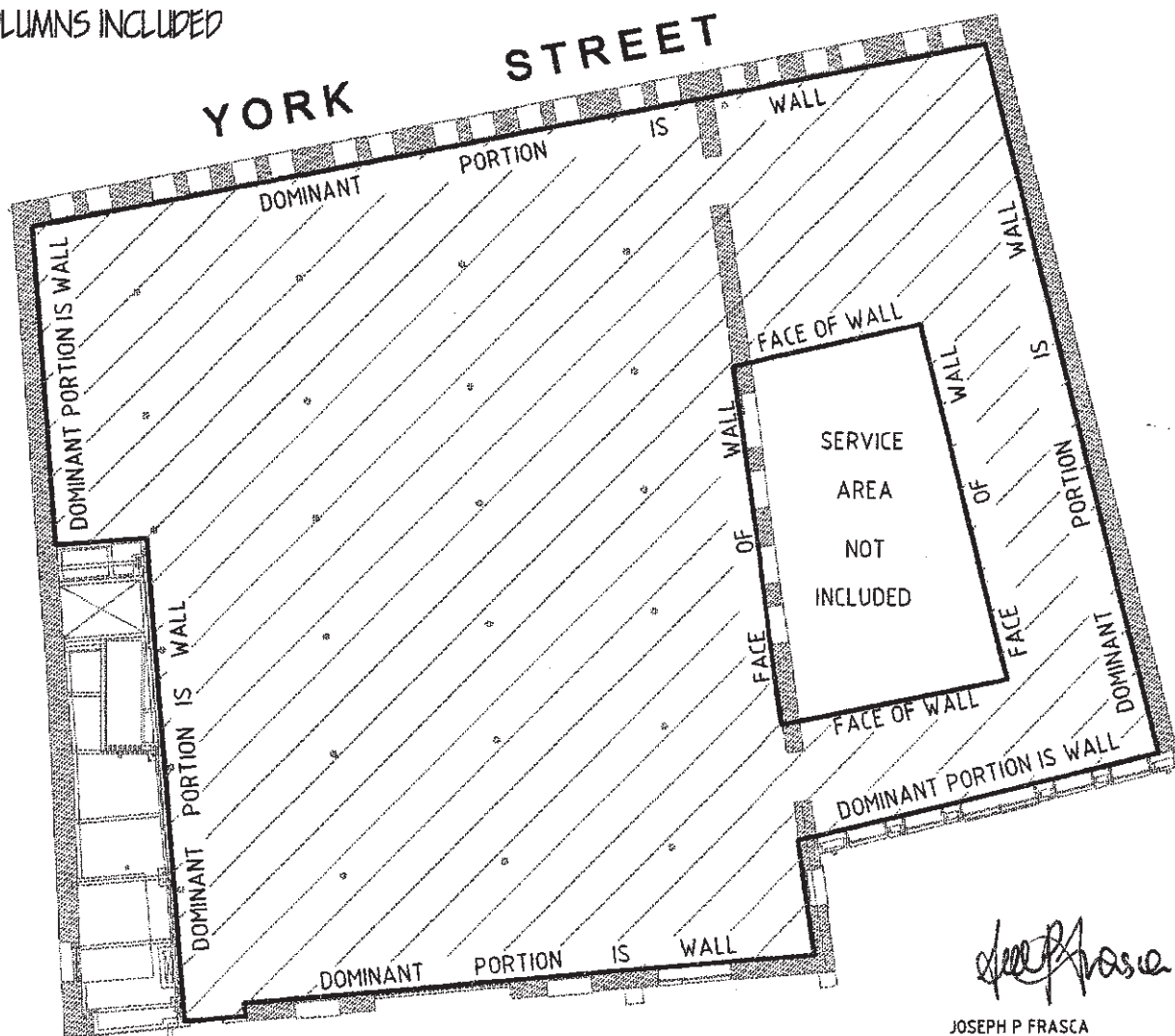

Joseph P. Frasca

JOSEPH P FRASCA
SURVEYOR REGISTERED UNDER
THE SURVEYORS ACT 1929

CLIENT : AUSTRALIAN GROWTH PROPERTIES

DATE: 11 NOVEMBER 1999

REF: 13126

NLAFINAL-YK5

CLEMENT & REID PTY.LTD.
Consulting Surveyors & Planners
135-153 New South Head Road - Edgecliff
Phone 9327 8706 Fax 9327 8218