

# SKETCH OF LEVEL 3

at 22-26 York Street - Sydney  
SHOWING NET LETTABLE AREA

**NET LETTABLE AREA = 823 SQ. MT'S.**

## NOTES:

1. NET LETTABLE AREA DETERMINED USING THE PRINCIPLES CONTAINED IN THE "PROPERTY COUNCIL OF AUSTRALIA METHOD OF MEASUREMENT FOR LETTABLE AREA" (MARCH 1997 EDITION)
2. AREAS STATED TO THE NEAREST SQUARE METRE
3. COLUMNS INCLUDED

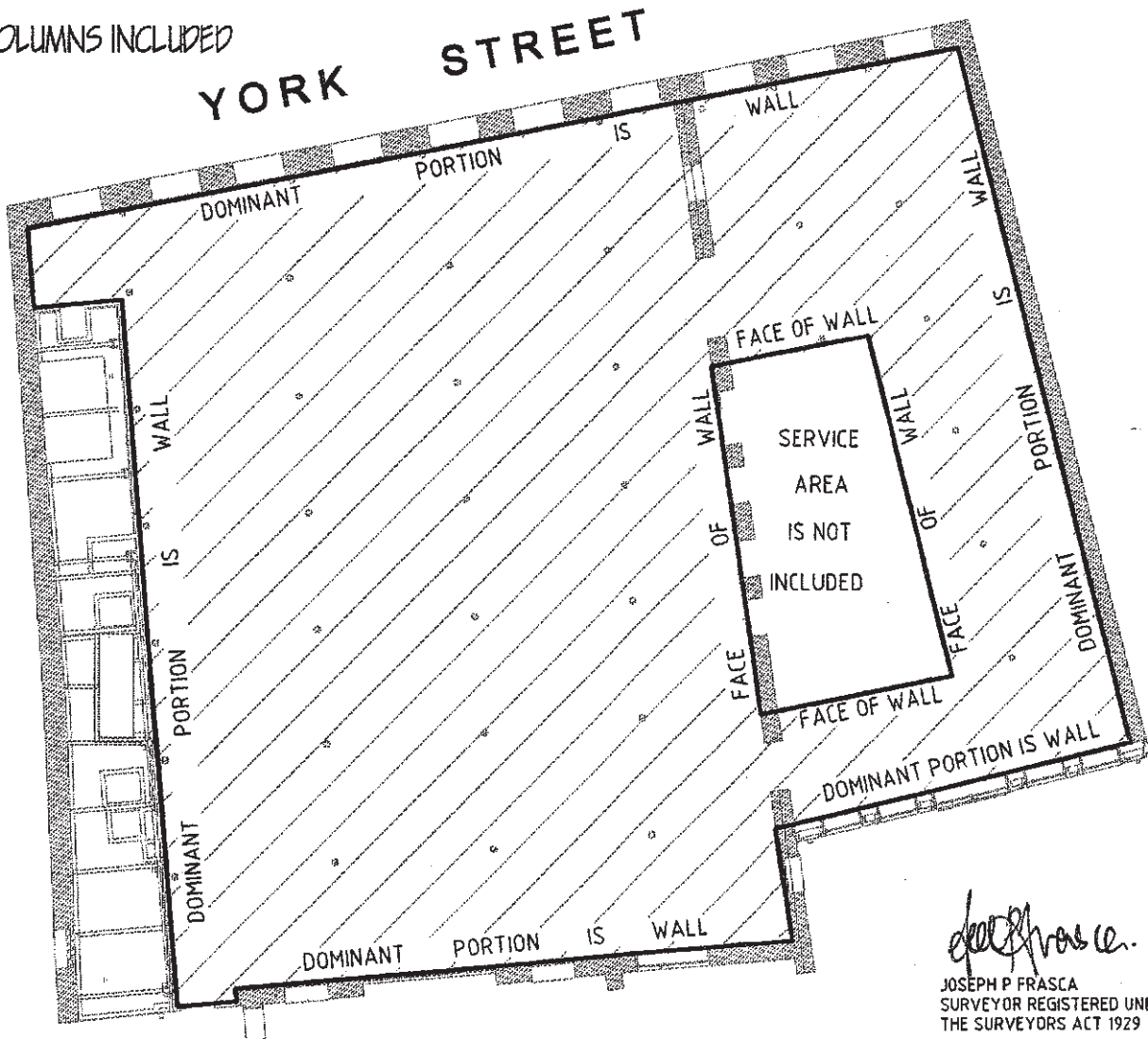

JOSEPH P. FRASCA  
SURVEYOR REGISTERED UNDER  
THE SURVEYORS ACT 1929

CLIENT : AUSTRALIAN GROWTH PROPERTIES

DATE: 11 NOVEMBER 1999

REF: 13126

NLAFINAL-YK3

CLEMENT & REID PTY.LTD.  
Consulting Surveyors & Planners  
135-153 New South Head Road - Edgecliff  
Phone 9327 8706 Fax 9327 8218